

R 50 · R 60 · R 69

00 = Engine
(Carburetor)

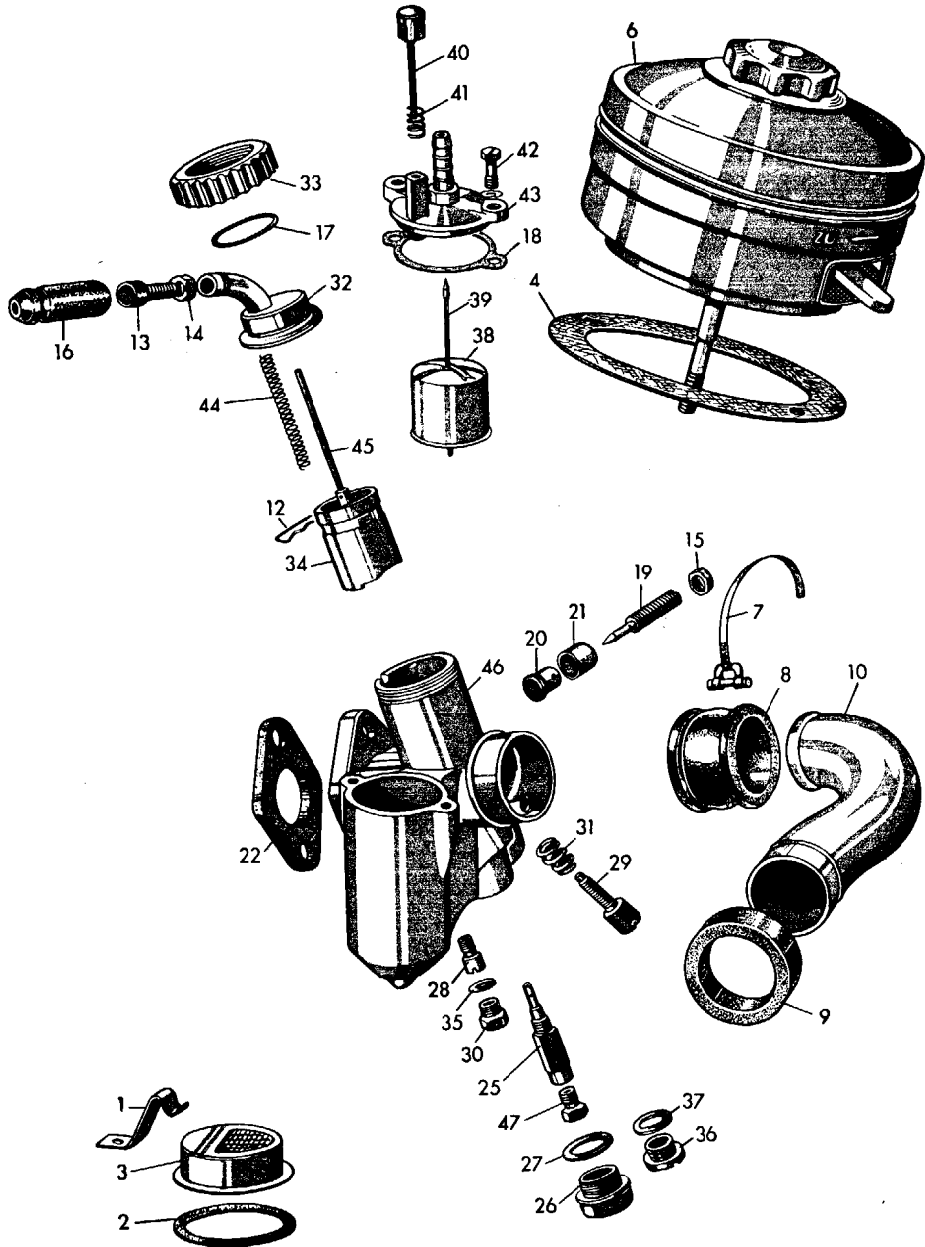

Ordering No.	Call-out No.	Description of Part	Qty.
Air filter in engine housing			
00 43 136	1	clip	1
99 63 493	2	gasket A 48×55 rubber	1
00 43 140	3	filter element	1
99 13 425	—	screw M 6×10—8 pho.black.	1
Air filter on transmission housing			
00 43 119	4	gasket	1
00 43 029	6	air filter	1
00 43 152	—	top cover gasket	1
00 43 156	—	housing gasket	1
00 43 144	—	filter element for filter 00 43 030	1
Air line			
00 43 104	7	hose clamp	4
00 43 161	8	rubber hose	2
00 43 163	9	gasket on transmission cover side	2
00 43 174	—	air intake, left, for R 50	1
00 43 175	10	air intake, right, for R 50	1
00 43 182	—	air intake, left, for R 60	1
00 43 183	10	air intake, right, for R 60	1
Carburetor			
00 39 038	—	carburetor, right, for R 50	1
00 39 039	—	carburetor, left, for R 50	1
00 39 042	—	carburetor, right, for R 60	1
00 39 044	—	carburetor, left, for R 60	1
00 39 176	12	clip	2
00 39 178	13	cable adjustment screw	2
00 39 182	14	nut	2
00 39 184	15	nut	2
00 42 111	16	rubber cap for cable	2
00 42 149	17	rubber O-ring	2
00 42 150	18	gasket	2

Ordering No.	Call-out No.	Description of Part	Qty.
00 39 181	19	air regulating screw	2
00 39 193	—	spring	2
00 39 183	20	insert	2
00 39 185	21	cap	2
00 42 146	22	gasket	2
00 39 124	25	jet needle (1308)	2
00 39 199	26	plug	2
00 42 130	27	gasket	2
00 39 135	28	idle jet No. 35	2
00 39 152	29	screw	2
00 39 196	30	screw	2
00 39 171	31	spring	2
00 39 111	—	top cover, left	1
00 39 112	32	top cover, right	1
00 39 217	33	ring nut	2
00 39 120	34	air slide	2
00 42 126	35	gasket	2
00 39 198	36	plug	2
00 42 134	37	gasket	2
00 39 187	38	float, 7 grams	2
00 39 288	39	float needle	2
00 39 260	40	tickler	2
00 39 164	41	tickler spring	2
00 39 165	—	clip	2
00 39 156	42	screw	4
00 39 256	43	float chamber cover	2
00 39 169	44	spring	2
00 39 274	45	jet needle	2
00 39 207	—	carburetor housing, left	1
00 39 208	46	carburetor housing, right	1
00 39 244	47	main jet No. 105	2
		Air filter in engine housing	
00 43 136	1	clip	1
99 63 493	2	gasket A 48×55 rubber	1

Ordering No.	Call-out No.	Description of Part	Qty.
00 43 140	3	filter element	1
99 13 425	—	screw M 6×10—8 G pho.black.	1
Air filter on transmission housing			
00 43 119	4	gasket	1
00 43 029	6	air filter	1
00 43 152	—	top cover gasket	1
00 43 156	—	housing gasket	1
00 43 144	—	filter element for filter 00 43 030	1
Air line			
00 43 162	—	seal on carburetor side	2
00 43 165	9	gasket on transmission side	2
00 43 166	—	ring for gasket on carburetor side	2
00 43 168	—	bushing for gasket on carburetor side	2
00 43 178	—	air intake, left	1
00 43 179	10	air intake, right	1
Carburetor			
00 39 034	—	carburetor, right	1
00 39 035	—	carburetor, left	1
00 39 175	12	clip	2
00 39 178	13	cable adjustment screw	1
00 39 182	14	nut	2
00 39 184	15	nut	2
00 42 111	16	rubber cap for cable	2
00 42 149	17	rubber O-ring	2
00 42 150	18	gasket	2
00 39 181	19	air regulating screw	2
00 39 193	—	spring	4
00 39 183	20	insert	2
00 39 185	21	cap	2
00 42 147	22	gasket	2
00 39 123	25	jet needle (1208)	2

Ordering No.	Call-out No.	Description of Part	Qty.
00 39 197	26	plug	2
00 42 130	27	gasket	2
00 39 135	28	idle jet No. 35	2
00 39 152	29	screw	2
00 39 196	30	screw	4
00 39 170	31	spring	2
00 39 218	—	top cover, left	1
00 39 219	32	top cover, right	1
00 39 216	33	ring nut	2
00 39 117	34	air slide	2
00 42 126	35	gasket	2
00 39 198	36	plug	2
00 42 134	37	gasket	2
00 39 187	38	float, 7 grams	2
00 39 288	39	float needle	2
00 39 260	40	tickler	2
00 39 164	41	tickler spring	2
00 39 165	—	clip	2
00 39 159	42	screw	4
00 39 256	43	float chamber cover	2
00 39 168	44	air slide spring	2
00 39 272	45	jet needle	2
00 39 213	—	carburetor housing, left	1
00 39 212	46	carburetor housing, right	1
00 39 245	47	main jet No. 115	2